

TBD Gawanv Court Unit #L32A/U19, Brevard, North Carolina 28712

TBD Gawanv Court Unit #L32A/U19, Brevard, North Carolina 28712

List Price: **\$35,000**
Closed Price: **\$29,000**

MLS#: **3911524** Category: **Lots/Acres/Farms** County: **Transylvania**
 Status: **CLOSD** City Tax Pd To: **No City Taxes Paid** Tax Val: **\$20,000**
 Subdivision: **Connestee Falls** Complex:
 Zoning Spec: **None** Zoning:
 Parcel ID: **8593-00-1156-000** Deed Ref: **20/477**
 Legal Desc: **U19 L032 Gawanv CT** Apx Lot Dim:
 Apprx Acres: **0.73**
 Lot Desc: **Private, Wooded**



General Information

Type: **Lot**
 Can Divide?: **No**
 \$/Acres: **\$39,726.03**
 Levels:

School Information

Elem: **Unspecified**
 Middle: **Unspecified**
 High: **Unspecified**

Land Information

Apprx Acres: **0.73**
 Acres Cleared:
 Acres Wood:
 Min SF to Bld: **1,500**
 Prop Found: **N/A**
 Rd Frontage:
 Lot Desc: **Private, Wooded**
 Restrictions: **Architectural Review, Manufactured Home Not Allowed, Short Term Rental Allowed, Square Feet**

Utility/Plan Information

Sewer: **Private Sewer**
 Water: **Community Well**
 Dwellings: **No**
 Beds Septic:

Additional Information

Prop Finance: **Cash**
 Ownership: **Seller owned for at least one year**
 Spcl Cond: **None**
 Rd Respons: **Privately Maintained Road**

Lease Considered: **No**

Features

Lot Description: **Private, Wooded**
 Waterbody Nm:

Lake/Wtr Amen: **Lake, Paddlesport Launch Site - Community**

Fixtures Exclsn: **No**
 Foundation: **N/A**
 Security Feat: **Community Security Service**
 Suitable Use: **Residential**
 Utilities: **Underground Utilities**
 Exterior Feat: **Other - See Remarks**
 Comm Feat: **Club House, Dog Park, Fitness Center, Gated Community, Golf Course, Outdoor Pool, Picnic Area, Playground, Tennis Court(s), Walking Trails**

Basement Dtls:
 Fireplaces:
 Inclusions:
 Fire Sprinkler:

Association Information

Subject to HOA: **Required**
 HOA Mangement: **CFPOA**
 HOA Email: **cfpoa@comporium.net**

Subj to CCRs: **Yes**
 HOA Phone: **828-885-2001**
 HOA 2 Email:

HOA Subj Dues: **Mandatory**
 Assoc Fee: **\$2142/Annually**

Remarks Information

Public Rmrks: **Build you dream home on these two combined lots. Easy build with basement or walk out crawl. Private lots back up to green space. House to the left is on 3 lot, house to the right has buffer between the lots. You will enjoy plenty of privacy. Close to East Fork Gate and amenities. Come explore beautiful Connestee Falls. Golf course, parks, lakes, playground, wellness center, tennis, bocce and pickle ball courts. Live where you play!!**
 Directions: **East for Gate, First right on Usdasdi, 2nd left on Gawanv. Lots are just past 29 Ganwanv.**

Listing Information

DOM: **257** CDOM: **711** Closed Date: 08/16/2023 12:00:05Sr Contr: **\$0**
 UC Dt: **06/20/23** DDP-End Dt: **08/18/2023** Closed Price: \$29,000 LTC: **314**

©2023 Canopy MLS. All rights reserved. Information herein deemed reliable but not guaranteed. Generated on 09/01/2023 12:24:53 PM
 The listing broker's offer of compensation is made only to participants of the MLS where the listing is filed.

MLS#: **3911524**

TBD Gawanv Ct Unit #L32A/U19, Brevard, NC 28712

Price: **\$29,000**



Lot 12 Silver Maple Trail Unit #12, Brevard, North Carolina 28712

Lot 12 Silver Maple Trail Unit #12, Brevard, North Carolina 28712

List Price: **\$29,900**

Closed Price: **\$29,900**

MLS#: **3585042** Category: **Lots/Acres/Farms** County: **Transylvania**
Status: **CLOSD** City Tax Pd To: **No City Taxes Paid** Tax Val: **\$40,000**
Subdivision: **Round Mountain Falls** Zoning: **None** Complex:
Zoning Spec: **None** Deed Ref: **381-850**
Parcel ID: **8540-69-9311-000**
Legal Desc: **L12 ROUND MOUNTAIN FALLS**
Apprx Acres: **3.55** Apx Lot Dim:
Lot Desc: **Creekfront, Level, Sloped, Stream/Creek, Views, Waterfall, Wooded**
Elevation: **2000-2500 ft.**



General Information

Type: **Lot**
Can Divide?: **No**
\$/Acres: **\$8,422.54**
Levels:

School Information

Elem: **Unspecified**
Middle: **Unspecified**
High: **Unspecified**

Land Information

Apprx Acres: **3.55**
Acres Cleared:
Acres Wood:
Min SF to Bld: **1,400**
Prop Found:
Rd Frontage:

Utility/Plan Information

Sewer: **Septic Needed**
Water: **Well Needed**
Dwellings: **No**
Beds Septic:

Lot Desc: **Creekfront, Level, Sloped, Stream/Creek, Views, Waterfall, Wooded**
Restrictions: **Architectural Review, Modular Not Allowed**

Additional Information

Prop Finance: **Cash, Construction Perm Loan, Conventional** Lease Considered: **No**
Ownership: **Seller owned for at least one year**
Spcl Cond: **None**
Rd Respons: **Privately Maintained Road**

Features

Lot Description: **Creekfront, Level, Sloped, Stream/Creek, Views, Waterfall, Wooded**
Waterbody Nm:
View: **Mountain(s), Year Round** Lake/Wtr Amen: **Covered Structure**
Fixtures Exclsn: **No** Doors:
Accessibility: Basement Dtls:
Road Surface: **Paved** Construct Type: **Site Built**
Roof: Patio/Porch:
Suitable Use: **Residential** Other Structure: **None**
Utilities: **Underground Utilities** Fire Sprinkler:
Comm Feat: **Gated Community, Lake Access, Pond, Recreation Area, Walking Trails**

Association Information

Subject to HOA: **Required** Subj to CCRs: **Yes** HOA Subj Dues: **Mandatory**
HOA Mangement: HOA Phone: Assoc Fee: **\$900/Annually**

Remarks Information

Public Rmrks: **Year round Mountain View lot with 2 creeks on the property. This is one of the most level lots in the area allowing for an easy build site. This lovely mountain community offers walking trails, a community pond and pavilion and multiple large waterfalls just a short hike away. Experience the beauty and tranquil surrounding in the heart of the Blue Ridge Mountains. The property is priced well below tax appraised value. Gate code required no drive byes.**
Directions: **From Brevard take 64 West to left on Frozen Creek rd. at the end take a right on Old Toxaway rd. Round Mountain Falls will be on your left. (Gate Code Required). Once through the gate take a right on Silver Maple Trail. Lot will be at the end on the left. (no Sign).**

Listing Information

DOM: **1,169** CDOM: **1,171** Closed Date: 08/17/2023 12:00:05Lr Contr: **\$0**
UC Dt: **04/29/23** DDP-End Dt: **08/10/2023** Closed Price: \$29,900 LTC: **1,296**

©2023 Canopy MLS. All rights reserved. Information herein deemed reliable but not guaranteed. Generated on 09/01/2023 12:24:53 PM
The listing broker's offer of compensation is made only to participants of the MLS where the listing is filed.

MLS#: **3585042**

Lot 12 Silver Maple Trl Unit #12, Brevard, NC 28712

Price: **\$29,900**





Lot 53 New Castle Road Unit #53, Brevard, North Carolina 28712

Lot 53 New Castle Road Unit #53, Brevard, North Carolina 28712

List Price: **\$52,000**
Closed Price: **\$47,500**

MLS#: **3869892** Category: **Lots/Acres/Farms** County: **Transylvania**
Status: **CLOSD** City Tax Pd To: **No City Taxes Paid** Tax Val: **\$65,000**
Subdivision: **Chasewood** Zoning: **None** Complex:
Zoning Spec: **None** Deed Ref: **689/ 177**
Parcel ID: **8574-54-9312-000**
Legal Desc: **S2 P1 L53 NEW CASTLE RD 1.71**
Apprx Acres: **1.70** Apx Lot Dim:
Lot Desc: **Paved, Sloped**
Elevation: **2000-2500 ft.**



General Information

Type: **Lot**
Can Divide?: **No**
\$/Acres: **\$27,941.18**
Levels:

School Information

Elem: **Unspecified**
Middle: **Unspecified**
High: **Unspecified**

Land Information

Apprx Acres: **1.70**
Acres Cleared:
Acres Wood:
Min SF to Bld: **1,600**
Prop Found:
Rd Frontage: **Private Road**
Lot Desc: **Paved, Sloped**
Restrictions: **Architectural Review, Manufactured Home Not Allowed, Modular Not Allowed, Square Feet**

Utility/Plan Information

Sewer: **Septic Needed**
Water: **Well Needed**
Dwellings: **No**
Beds Septic:

Additional Information

Prop Finance: **Cash, Construction Perm Loan, Conventional** Lease Considered: **No**
Ownership: **Seller owned for at least one year**
Spcl Cond: **None**
Rd Respons: **Privately Maintained Road**

Features

Lot Description: **Paved, Sloped**
View: **Winter**
Fixtures Exclsn: **No**
Accessibility:
Exterior Cover:
Road Surface: **Paved**
Roof:
Suitable Use: **Residential**
Utilities: **Underground Utilities**
Doors:
Basement Dtls:
Construct Type: **Site Built**
Road Frontage: **Private Road**
Patio/Porch:
Other Structure: **None**
Fire Sprinkler:

Association Information

Subject to HOA: **Required** Subj to CCRs: **Yes** HOA Subj Dues: **Mandatory**
HOA Mangement: HOA Phone: **843-860-3654** Assoc Fee: **\$800/Annually**
HOA Email: **president@chasewoodpoa.com** HOA 2 Email:

Remarks Information

Public Rmrks: **Located less than 10 minutes from downtown Brevard. This 1.7 acres lot is located in Chasewood Subdivision. The property has the potential for mountain views with some additional clearing. There is a gentle slope and a roughed in driveway. Expired 3 bedroom septic permit on file. This lot has ample road frontage and sits up above the community paved road. Chasewood is a lovely community with a minimum build size of 1,600 sq ft. The Annual POA does are \$800 a year. There is public access to the French Broad River just down the road form the entrance of the subdivision. If you are looking for a lot with a gentle build site in community of nice homes look no further.**
Directions: **From Brevard take 64 W. and continue straight on Country Club rd. Take a right on South Country Club Rd. Continue till stop sign. Take a left on Island Ford rd to your first right into Chase wood Subdivsion. Take your first left inside the subdivision on Coventry Drive. Take a right on Londonderry Dr. Turn Right on New Castle Rd. Lot will be last lot on your right be fore South Hampton.**

Listing Information

DOM: **296** CDOM: **884** Closed Date: 08/04/2023 12:00:05Lr Contr: **\$0**
UC Dt: **04/13/23** DDP-End Dt: **07/28/2023** Closed Price: \$47,500 LTC: **409**

©2023 Canopy MLS. All rights reserved. Information herein deemed reliable but not guaranteed. Generated on 09/01/2023 12:24:53 PM
The listing broker's offer of compensation is made only to participants of the MLS where the listing is filed.

MLS#: **3869892**

Lot 53 New Castle Rd Unit #53, Brevard, NC 28712

Price: **\$47,500**

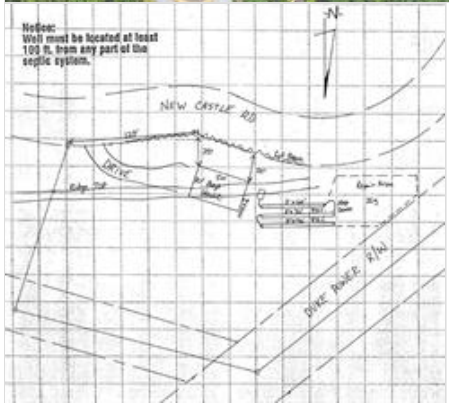

Community entrance
Community entrance

Community entrance
Community entrance

Community entrance
Community entrance

L035 Frazier Road Unit #C35, Brevard, North Carolina 28712

L035 Frazier Road Unit #C35, Brevard, North Carolina 28712

List Price: **\$55,000**
Closed Price: **\$55,000**

MLS#: **4005878** Category: **Lots/Acres/Farms** County: **Transylvania**
Status: **CLOSED** City Tax Pd To: **No City Taxes Paid** Tax Val: **\$35,000**
Subdivision: **Sherwood Forest** Zoning: **PUD** Complex:
Parcel ID: **8592-95-0227-000** Deed Ref: **417/1**
Legal Desc: **S C L035 FRAZIER RD**
Apprx Acres: **0.86** Apx Lot Dim: **130X256**
Lot Desc: **Green Area, Open Lot, Paved, Private, Rolling Slope, Sloped, Trees**
Elevation: **2500-3000 ft.**



General Information

Type: **Lot**
Can Divide?: **No**
\$/Acres: **\$63,953.49**
Levels:

School Information

Elem: **Brevard**
Middle: **Brevard**
High: **Brevard**

Land Information

Apprx Acres: **0.86**
Acres Cleared: **0.00**
Acres Wood: **0.86**
Min SF to Bld: **1,100**
Prop Found:
Rd Frontage: **Private Road**
Lot Desc:

Utility/Plan Information

Sewer: **Septic Needed**
Water: **Public Water**
Dwellings: **No**
Beds Septic:

Restrictions:

Architectural Review, Manufactured Home Not Allowed, Modular Not Allowed, Square Feet

Additional Information

Prop Finance: **Cash**
Ownership: **Seller owned for at least one year**
Spcl Cond: **None**
Rd Respons: **Privately Maintained Road**

Lease Considered: **No**

Features

Lot Description: **Green Area, Open Lot, Paved, Private, Rolling Slope, Sloped, Trees**
Waterbody Nm:
View: **Mountain(s)**
Fixtures Exclsn: **No**
Exterior Cover:
Road Surface: **Paved**
Roof:
Other Equipmnt:
Suitable Use: **Residential**
Utilities: **Cable Available, Satellite Internet Available, Underground Utilities**
Comm Feat: **Club House, Dog Park, Golf Course, Lake Access, Outdoor Pool, Picnic Area, Playground, Pond, Putting Green, Recreation Area, RV/Boat Storage, Tennis Court(s), Walking Trails, Other**

Lake/Wtr Amen: **Dock - Community, Pier - Community**
Doors:
Basement Dtls:
Road Frontage: **Private Road/178**
Patio/Porch:
Other Structure: **None**
Horse Amenities: **None**
Fire Sprinkler:

Association Information

Subject to HOA: **Required** Subj to CCRs: **Yes** HOA Subj Dues: **Mandatory**
HOA Mangemnt: **SFHA** HOA Phone: **8282267267** Assoc Fee: **\$616/Annually**
HOA Email: **info@sherwoodforestnc.com** HOA 2 Email:
Spc Assess Cnfrm: **Yes/1500**

Remarks Information

Public Rmrks: **A gently sloping, easy to build lot filled with rich hardwood trees, rhodos, mountain laurels and ferns. Its .86 acre rectangular lot extends 356' deep with 130' of road frontage. Members enjoy five lakes, 25 miles of community maintained trails with meandering streams and gentle waterfalls, unique native gorgeous vegetation, heated Junior Olympic swimming pool, tennis courts, 18 hole par 3 golf course, and a community garden. Approximately 50% of Sherwood Forest is Green Area. We also have nature walks, lecture series, and sometimes square dances in the Robin Hood Barn. Sherwood Forest, a 1000 acres mountain development committed to environmental preservation, is approximately 45 minutes from both Greenville SC and Asheville NC airports and about 9 miles to Dupont Forest. 10 minutes from Brevard. Great opportunity. Call now!**

Directions: **From Brevard take Hwy 276 approximately 8 miles to 2nd Sherwood Forest entrance, turn right on Cardinal Rd and follow to Frazier, turn left and look for sign on the right.**

Listing Information

DOM: **48** CDOM: **49** Closed Date: **08/28/2023 12:00:00** Sr Contr: **\$0**
UC Dt: **04/18/23** DDP-End Dt: **07/15/2023** Closed Price: **\$55,000** LTC: **180**

©2023 Canopy MLS. All rights reserved. Information herein deemed reliable but not guaranteed. Generated on 09/01/2023 12:24:53 PM
The listing broker's offer of compensation is made only to participants of the MLS where the listing is filed.

MLS#: **4005878**
L035 Frazier Rd Unit #C35, Brevard, NC 28712
Price: **\$55,000**

53R High Hemlock Trail, Brevard, North Carolina 28712

53R High Hemlock Trail, Brevard, North Carolina 28712

List Price: **\$90,000**
Closed Price: **\$85,000**

MLS#: **4048846** Category: **Lots/Acres/Farms** County: **Transylvania**
Status: **CLOSD** City Tax Pd To: **No City Taxes Paid** Tax Val: **\$50,000**
Subdivision: **Mountain Brook** Zoning: **RES** Complex:
Parcel ID: **8574-96-0665-000** Deed Ref: **1069/700**
Legal Desc: **L 53R HIGH HEMLOCK TRAIL 1.02** Apx Lot Dim:
Apprx Acres: **1.02**
Lot Desc: **Wooded**



General Information

Type: **Lot**
Can Divide?:
\$/Acres: **\$83,333.33**
Levels:

School Information

Elem: **Brevard**
Middle: **Brevard**
High: **Brevard**

Land Information

Apprx Acres: **1.02**
Acres Clear:
Acres Wood:
Min SF to Bld: **1,600**
Prop Found:
Rd Frontage:
Lot Desc: **Wooded**
Restrictions: **Architectural Review**

Utility/Plan Information

Sewer: **Septic Needed**
Water: **Well Installed**
Dwellings: **No**
Beds Septic:

Additional Information

Prop Finance: **Cash, Conventional** Lease Considered: **No**
Ownership: **Seller owned for at least one year**
Spcl Cond: **None**
Rd Respons: **Privately Maintained Road**

Features

Lot Description: **Wooded**
Fixtures Exclsn: **No** Basement Dtls:
Road Surface: **Paved** Patio/Porch:
Suitable Use: **Residential** Fire Sprinkler:

Association Information

Subject to HOA: **Required** Subj to CCRs: **Yes** HOA Subj Dues:
HOA Mangement: HOA Phone: Assoc Fee: **\$853/Annually**

Remarks Information

Public Rmrks: **Level lot in a premier mountain community in Brevard. Mature hardwoods and rhododendron make you feel tucked into the woods yet you are only 10 minutes away from downtown. This lot has an active 3 BR septic and well permit on file and do not expire until 2027. Topo survey completed as well. With these being completed, it can save you several months on your construction timeline. Brevard is well known for Pisgah National Forest, Dupont State Forest and the famous Music Center. Come live where you play!**
Directions: **From downtown Brevard take 64 W and stay straight on Country Club Rd. Right on South Country Club Rd., right into Mountain Brook. Stay straight on Mountain Brook Trail. Take left onto High Hemlock. Vacant lot will be on the left marked with #53.**

Listing Information

DOM: **19** CDOM: **21** Closed Date: **08/23/2023 12:00:00** Sr Contr: **\$0**
UC Dt: **08/01/23** DDP-End Dt: **08/16/2023** Closed Price: **\$85,000** LTC: **41**

©2023 Canopy MLS. All rights reserved. Information herein deemed reliable but not guaranteed. Generated on 09/01/2023 12:24:54 PM
The listing broker's offer of compensation is made only to participants of the MLS where the listing is filed.

MLS#: **4048846**
53R High Hemlock Trl, Brevard, NC 28712
Price: **\$85,000**

Turkey Pen Road, Hendersonville, North Carolina 28759-2876

Turkey Pen Road, Hendersonville, North Carolina 28759-2876

List Price: **\$150,000**
Closed Price: **\$150,000**

MLS#: **4043604** Category: **Lots/Acres/Farms** County: **Transylvania**
 Status: **CLOSD** City Tax Pd To: **No City Taxes Paid** Tax Val: **\$228,480**
 Subdivision: Complex:
 Zoning Spec: **MU** Zoning: **None**
 Parcel ID: **9519-15-3700-000 + more** Deed Ref: **315-627**
 Legal Desc: **HWY 280 OFF, TURKEY PEN RD**
 Apprx Acres: **10.00** Apx Lot Dim:
 Lot Desc: **Creekfront, Hilly, Level, Private, Steep Slope, Stream/Creek, Trees, Wooded**



General Information

Type: **Acreage**
 Can Divide?:
 \$/Acres: **\$15,000.00**
 Levels:

School Information

Elem: **Unspecified**
 Middle: **Unspecified**
 High: **Unspecified**

Land Information

Apprx Acres: **10.00**
 Acres Cleared:
 Acres Wood: **10.00**
 Min SF to Bld: **0**
 Prop Found:
 Rd Frontage: **State Road**
 Lot Desc: **Creekfront, Hilly, Level, Private, Steep Slope, Stream/Creek, Trees, Wooded**
 Restrictions: **No Restrictions**

Utility/Plan Information

Sewer: **None**
 Water: **None**
 Dwellings: **No**
 Beds Septic:

Additional Information

Prop Finance: **Cash** Lease Considered: **No**
 Ownership: **Seller owned for at least one year**
 Spcl Cond: **None**
 Rd Respons: **Publicly Maintained Road**
 Addl Parcels: **9519163095**

Features

Lot Description: **Creekfront, Hilly, Level, Private, Steep Slope, Stream/Creek, Trees, Wooded**
 Waterbody Nm: **Creek** Lake/Wtr Amen: **None**
 Fixtures Exclsn: **No** Basement Dtls:
 Exterior Cover: Road Frontage: **State Road**
 Road Surface: **Gravel** Patio/Porch:
 Roof: Other Structure: **None**
 Other Equipmnt: Horse Amenities: **None**
 Suitable Use: **Residential** Fire Sprinkler:
 Comm Feat: **None**

Association Information

Subject to HOA: **None** Subj to CCRs: **No** HOA Subj Dues: **No**
 Prop Spc Assess: **No**
 Spc Assess Cnfrm: **No**

Remarks Information

Public Rmrks: **A once in a lifetime opportunity to own un-restricted land right down the road from the Turkey Pen Trailhead in Mills River, NC? This 10 acre parcel sits right between Transylvania (6.5 Acres) and Henderson County (3.5 Acres) The 3.5 acres in Henderson County has a relatively level and clear build site just on the other side of woody branch. Suitable use would be single family home or place to camp with your family. Enjoy a short walk on the Turkey Pen Trail which takes you to South Mills River and the Pisgah National Forest that is idea for fly fishing, hiking, horseback riding, and mountain biking. Lastly, this parcel is convenient to shopping, dining, and Asheville Regional Airport.**

Directions: **Take I-26 E/US-74 E and NC-280 W to Turkey Pen Rd in Mills River. Drive down the gravel road about .2 of a mile and sign is on the left hand side of road.**

Listing Information

DOM: **11** CDOM: **14** Closed Date: 08/15/2023 12:00:05Lr Contr: **\$0**
 UC Dt: **07/07/23** DDP-End Dt: **08/10/2023** Closed Price: \$150,000 LTC: **50**

©2023 Canopy MLS. All rights reserved. Information herein deemed reliable but not guaranteed. Generated on 09/01/2023 12:24:54 PM
 The listing broker's offer of compensation is made only to participants of the MLS where the listing is filed.

MLS#: **4043604**

Turkey Pen Rd, Hendersonville, NC 28759

Price: **\$150,000**

Turkey Pen Rd is a dead end road where the Turkey Pen trailhead is located. 5-10 min walk from acreage.

South Mills River Trail located at the end of Turkey Pen Rd.

Woody Branch Potential Driveway.

Welcome to Turkey pen (Pisgah National Forest)

Turkey Pen State Forest Road

Potential Driveway up to relatively level build site. Build Site is flagged.

Build Site on 3.5 acres in Henderson County

